



Est. 1883

# BHSU Town Hall Library Project Update

March 30, 2020

# INTRODUCTIONS - BHSU PRESENTERS



Kathy Johnson

Vice President for Finance &  
Administration

Randy Culver

Associate Vice President for Facilities  
& Sustainability

# INTRODUCTIONS - ARCHITECTS

Steve Williams

Williams & Associates Architects

Kevin Huse

Ratio Architects



# BOARD OF REGENTS BUILDING COMMITTEE



President Nichols, BHSU

Executive Director, SD Board of Regents

John Bastian, Board of Regents member

Stacy Watters, State Engineer

# UNIVERSITY BUILDING COMMITTEE

Scott Ahola, Library

Chris Crawford, Provost

Fred Nelson, IT

Randy Culver, Facilities

Amy Fuqua, Deans

Kathy Johnson, Administration

Aaron Bauerly, Library

Jeff Winter, Faculty/Math Center

Janette Hettick, Advising

Jodi Gabriel, Staff Senate

Hans Nelson, Career Center

Hannah Neumiller, Student Senate

# LEGISLATIVE PROJECT AUTHORIZATION

## 2012 SD Legislature

- HB1051

## 2020 SD Legislature

- HB1045
- SB43



# ABOUT THE LIBRARY



- Built in 1973
- Nearly 50 years old
- Systems have been maintained, but not upgraded
- 62,036 GSF
- Significant changes in higher education since 1973

# ESTIMATED COST

Construction	\$6,242,562
2 <sup>nd</sup> Floor Addition	\$1,330,000
Accessibility	\$200,000
Site Work	\$300,000
Contingency (8%)	\$645,805
A/E Fees	<u>\$653,878</u>
<b>Total</b>	<b>\$9,372,245</b>





# FUNDING

HEFF Bonding	\$3,000,000
M&R Bonding	\$2,400,000
BHSU M&R	\$3,917,245
Performance Contract	\$30,000
Black Hills Energy	<u>\$25,000</u>
<b>Total</b>	<b>\$9,372,245</b>



# TIMELINE

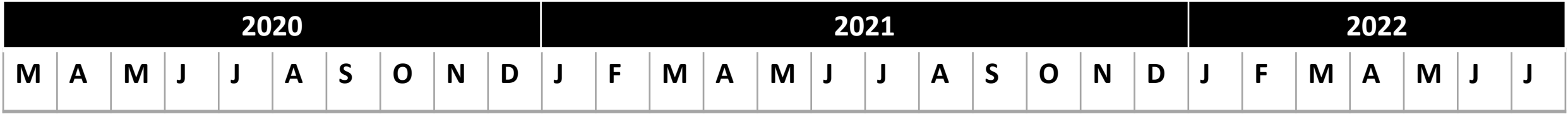

Design Plan



Construction Documents



Bid



Vacate Library & Mobilize



Construction

# MAIN FEATURES

- Second story addition
- New open staircase
- Student Success Center
- Outdoor café seating
- New entrance on the west
- Major infrastructure upgrade
- Collections/Archives



# STUDENT SUCCESS CENTER



- Professional advising
- Tutoring
- Math Assistance Center
- Writing Assistance Center
- Discrete study spaces
- IT Help Desk
- Career Center (?)

# INFRASTRUCTURE UPGRADE

- HVAC
- Electrical
- Lighting
- Fire sprinkler system
- Accessibility
- Electronic Doors
- Data/Technology



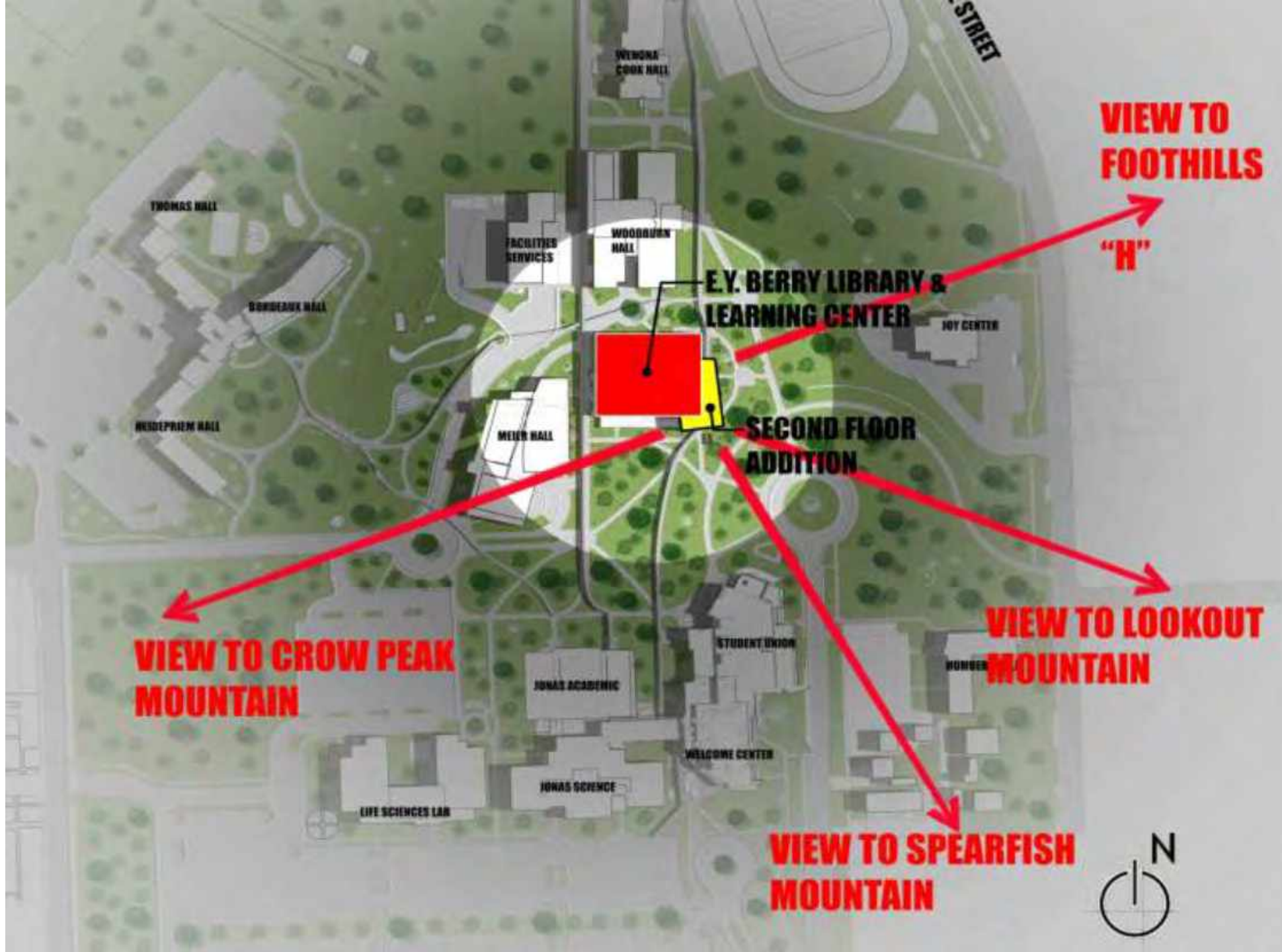







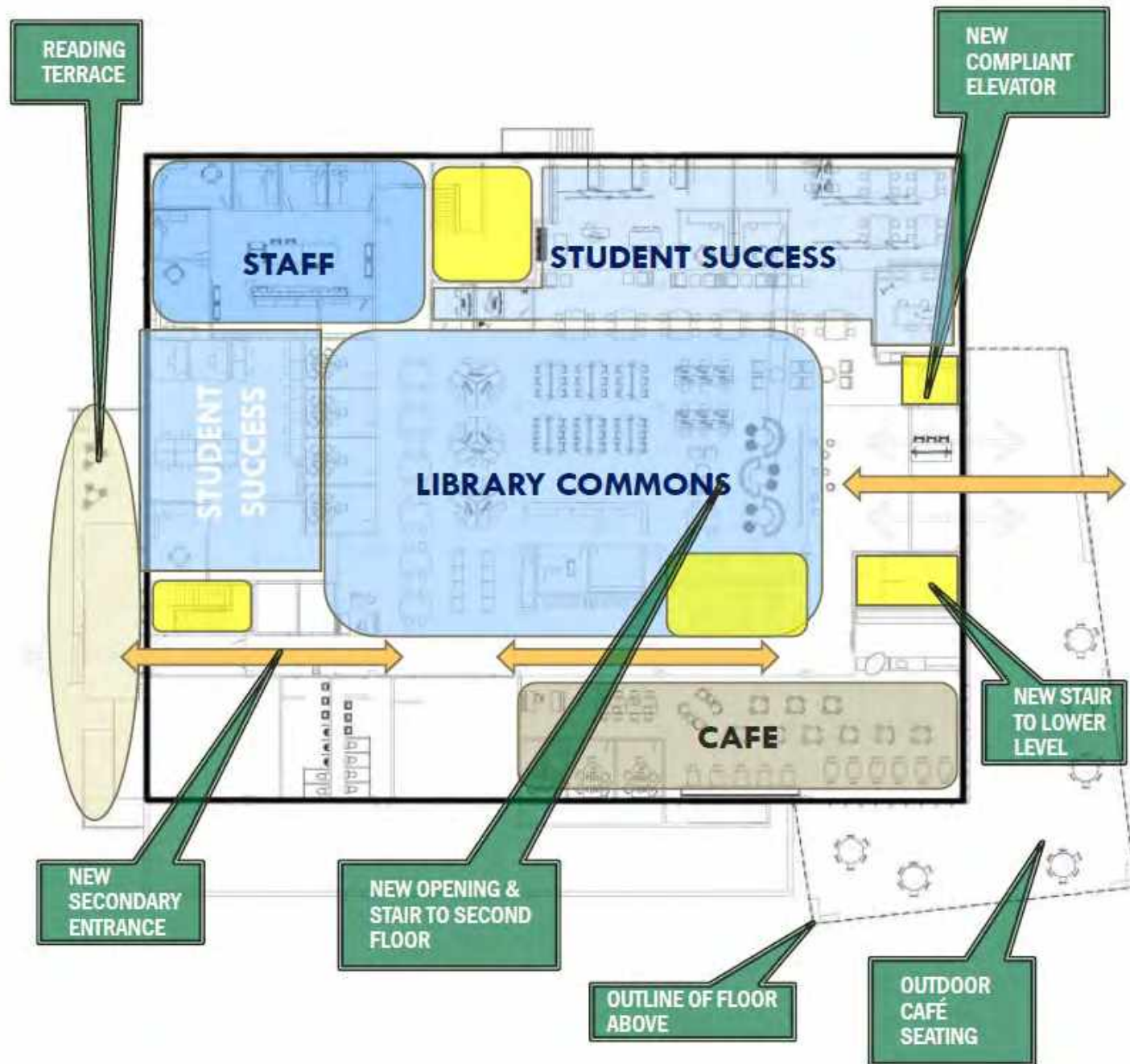

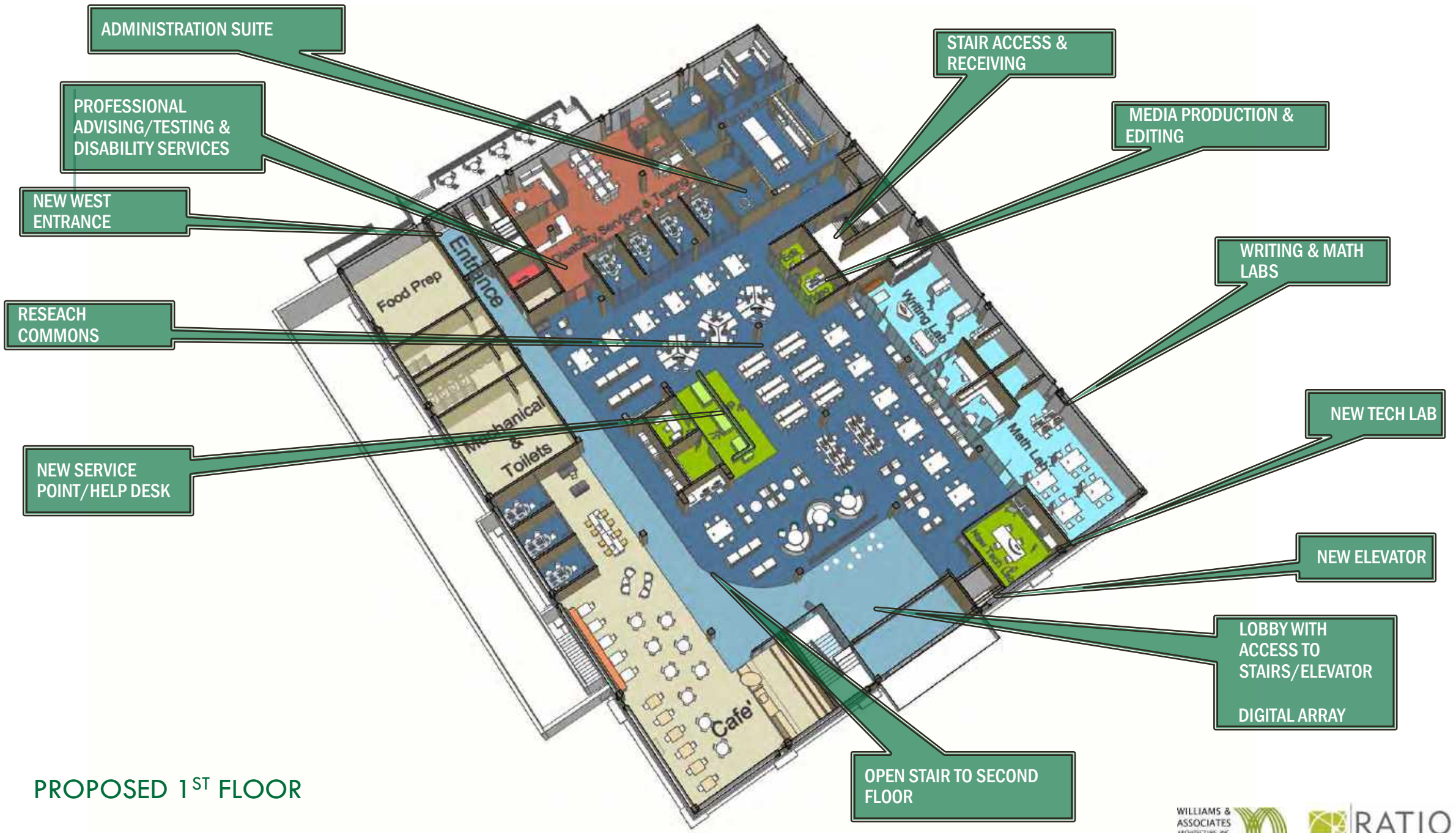

PROPOSED 1<sup>ST</sup> FLOOR



PROPOSED 1<sup>ST</sup> FLOOR



PROPOSED 1<sup>ST</sup> FLOOR

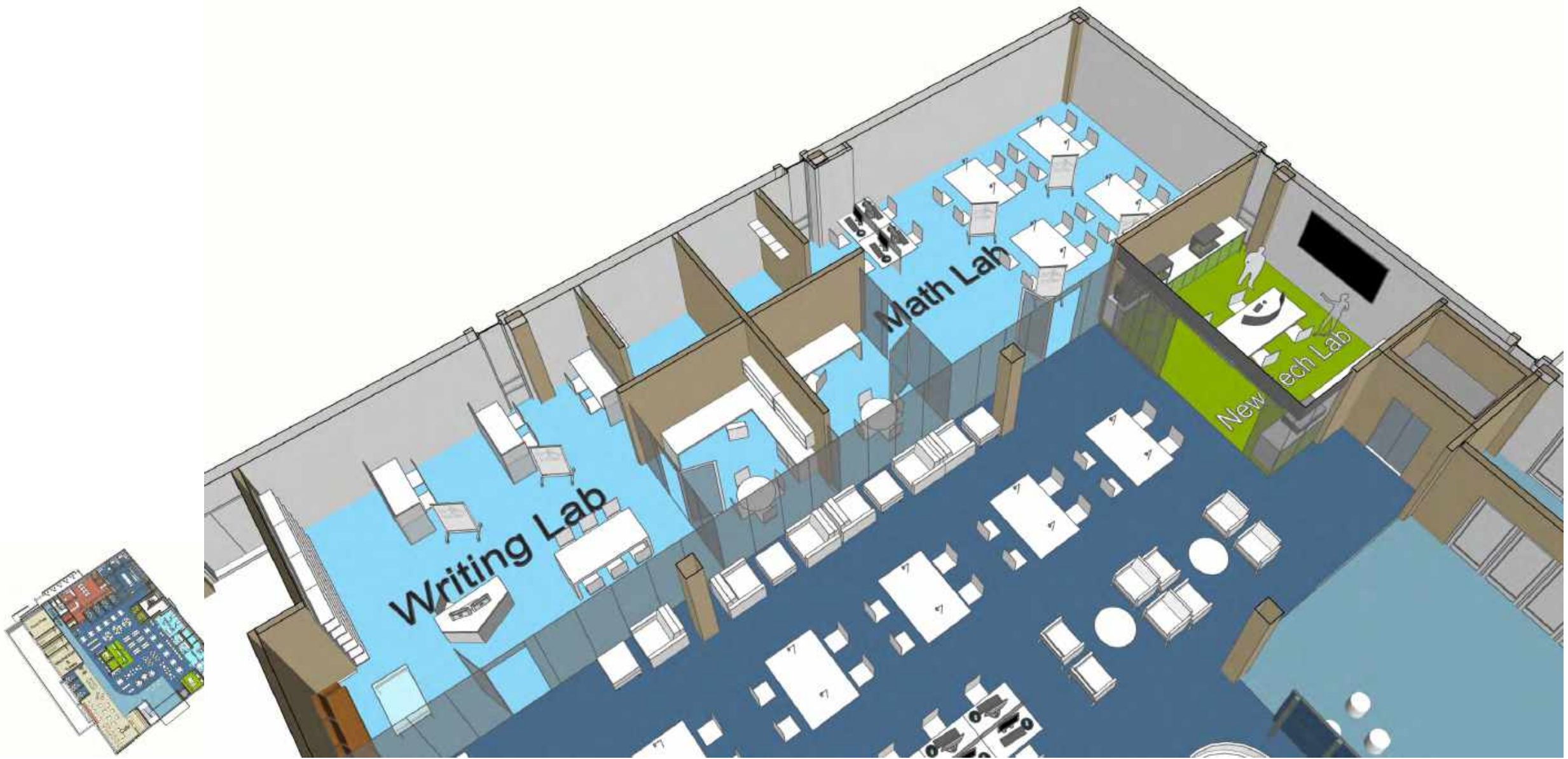

PROPOSED 1<sup>ST</sup> FLOOR

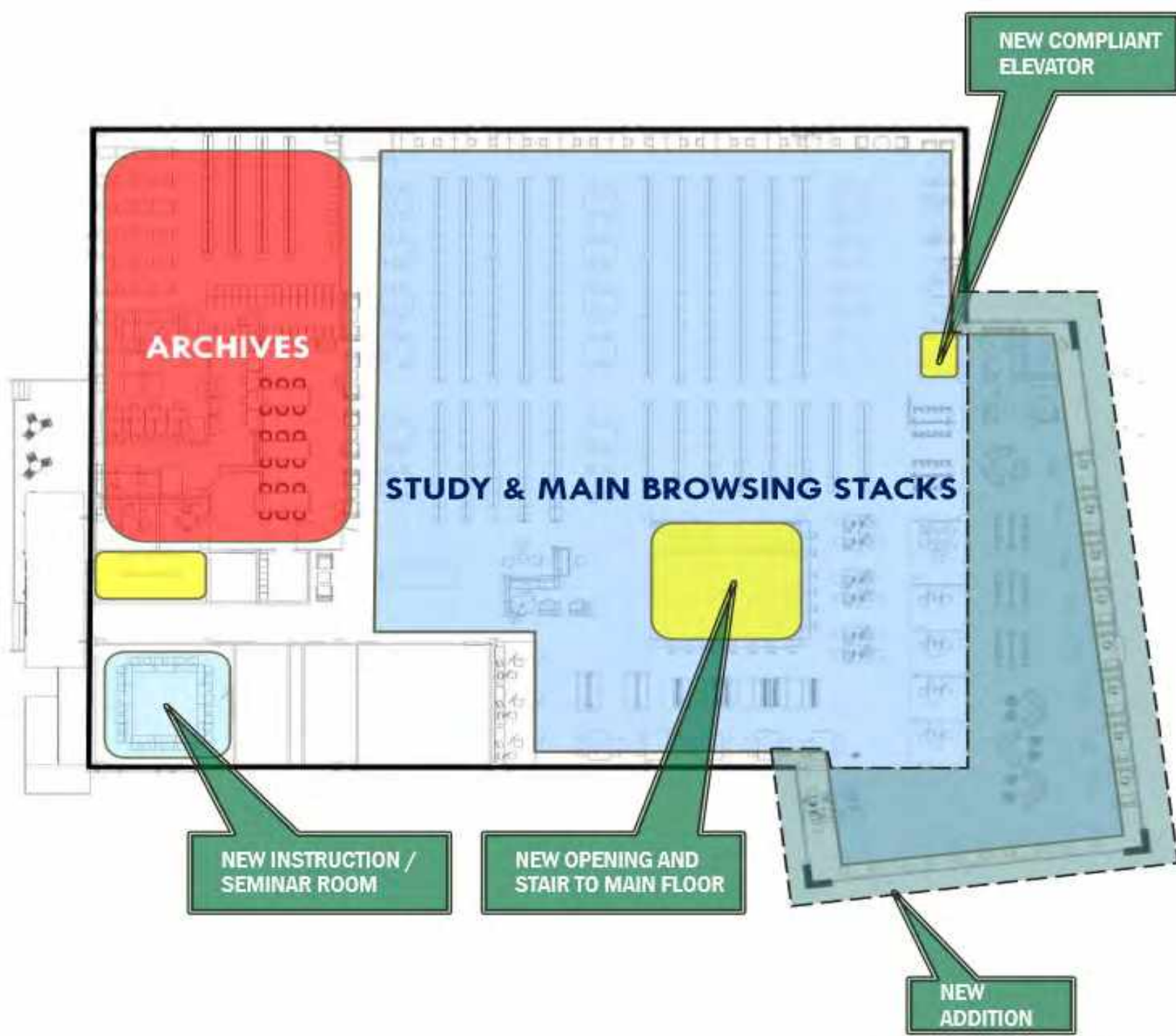

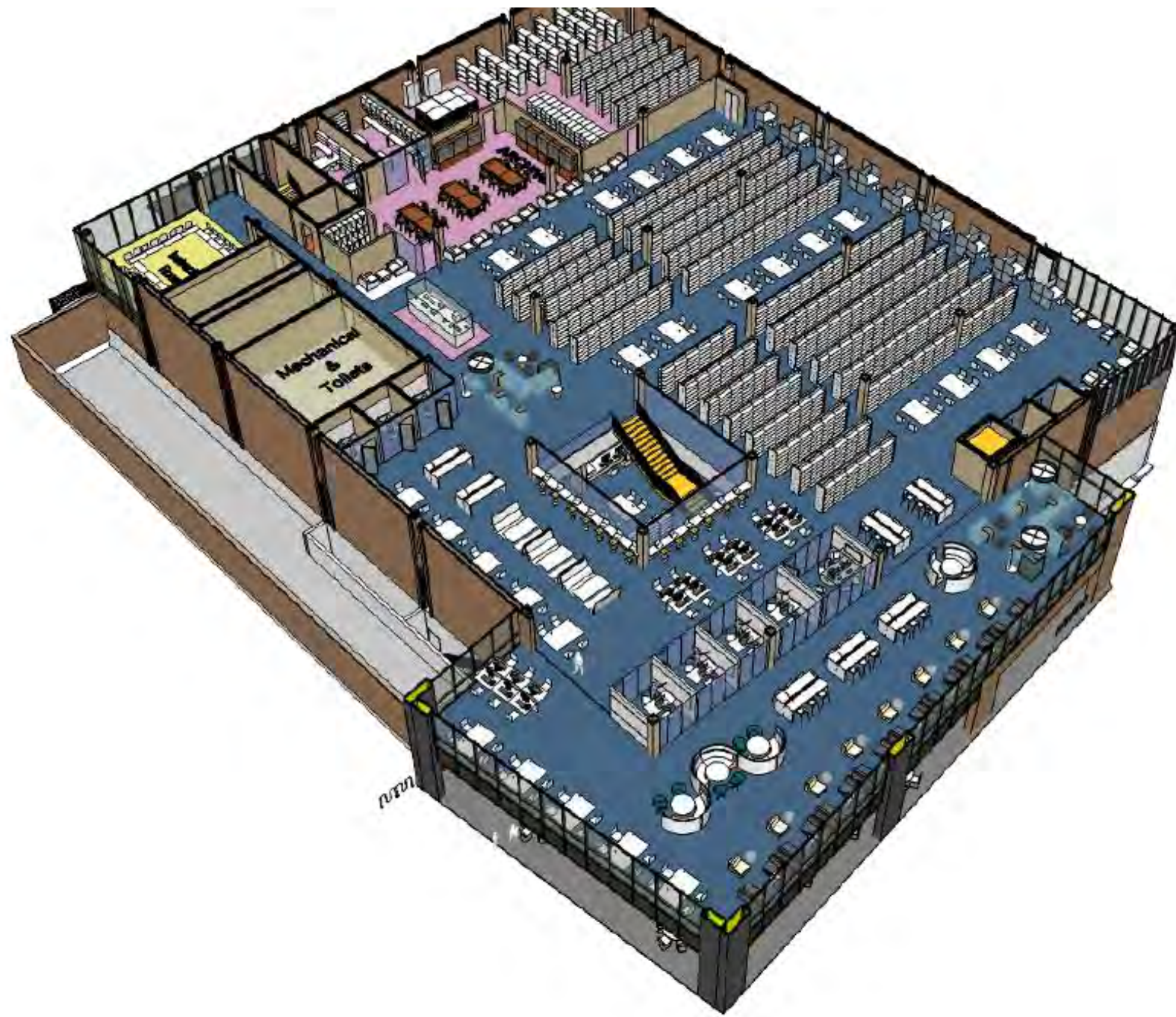

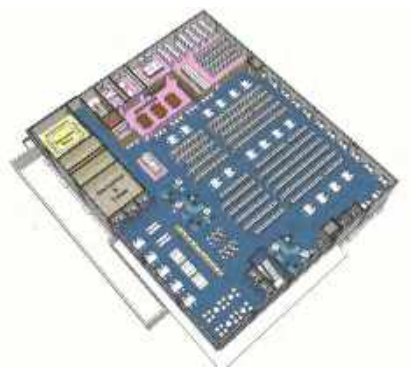
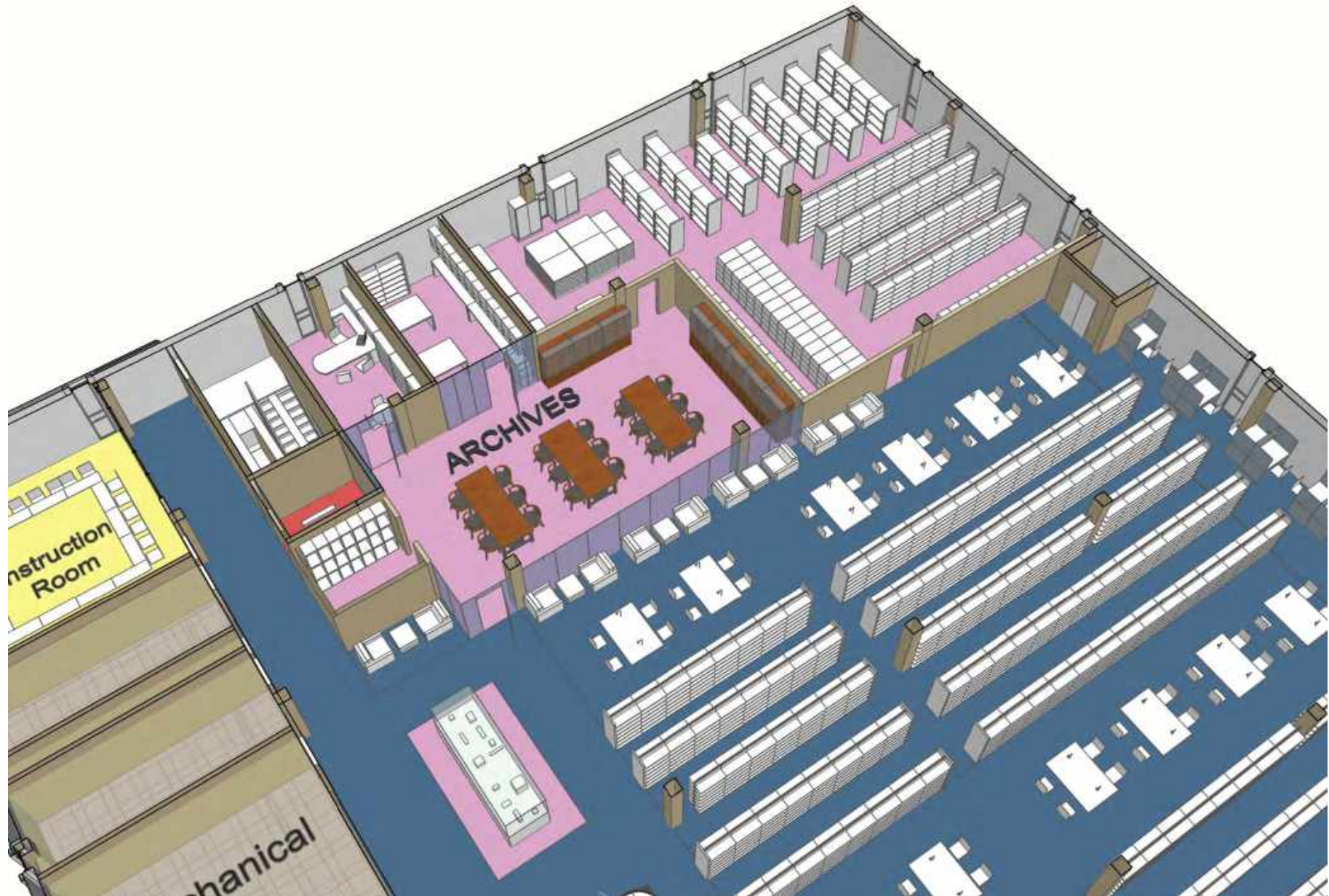
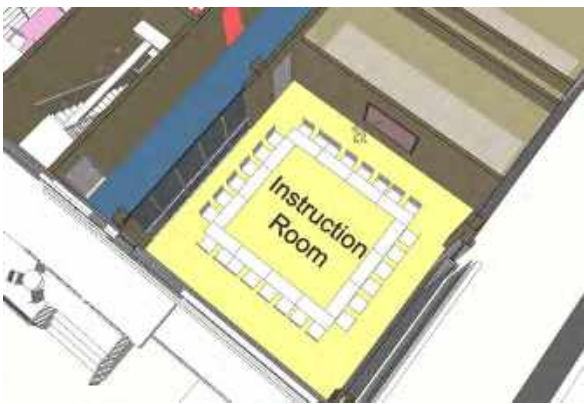

PROPOSED 2ND FLOOR



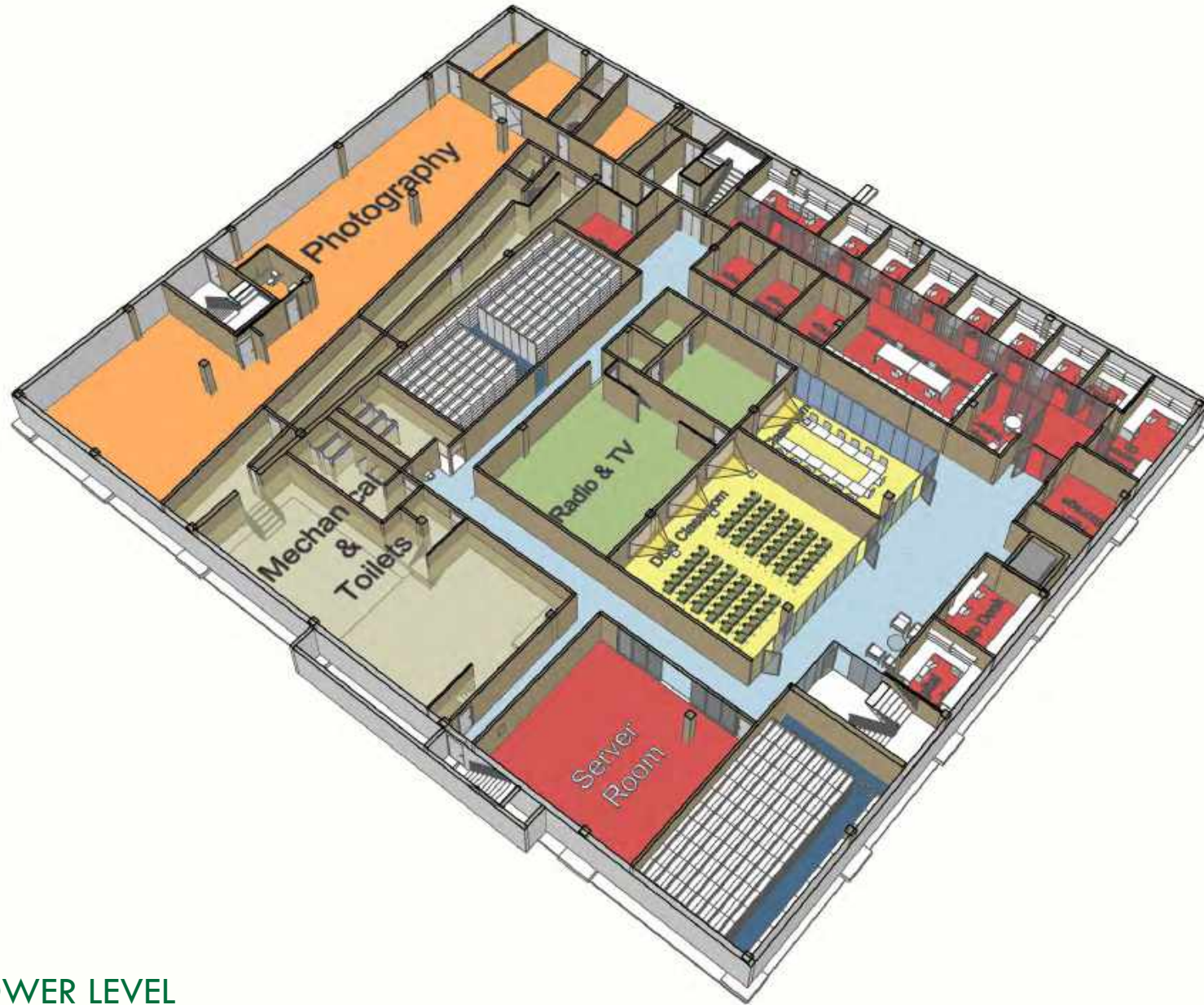

PROPOSED LOWER LEVEL

# RELOCATION

18 months

Spring 2021 - Spring 2022

Departments

- Library
- IT
- Disabilities/Testing
- Math & Writing Centers
- DDN &GEC
- Einstein's



# UNIVERSITY BUILDING COMMITTEE

Scott Ahola, Library

Chris Crawford, Provost

Fred Nelson, IT

Randy Culver, Facilities

Amy Fuqua, Deans

Kathy Johnson, Administration

Aaron Bauerly, Library

Jeff Winter, Faculty/Math Center

Janette Hettick, Advising

Jodi Gabriel, Staff Senate

Hans Nelson, Career Center

Hannah Neumiller, Student Senate



Where *Anything* is possible